

# THE BERKELEY

LONDON

*Picture a world-class hotel that excels at everything you'd expect, whilst offering pleasures and discoveries you never anticipated. Then, think of a staff of explorers, curators and connoisseurs who delight in bringing you the latest indulgences, whilst presenting their own interpretation of the classics. Now imagine a hotel where all this is not the goal, but the starting point. Welcome to The Berkeley.*

BLUE BAR



ROOFTOP POOL

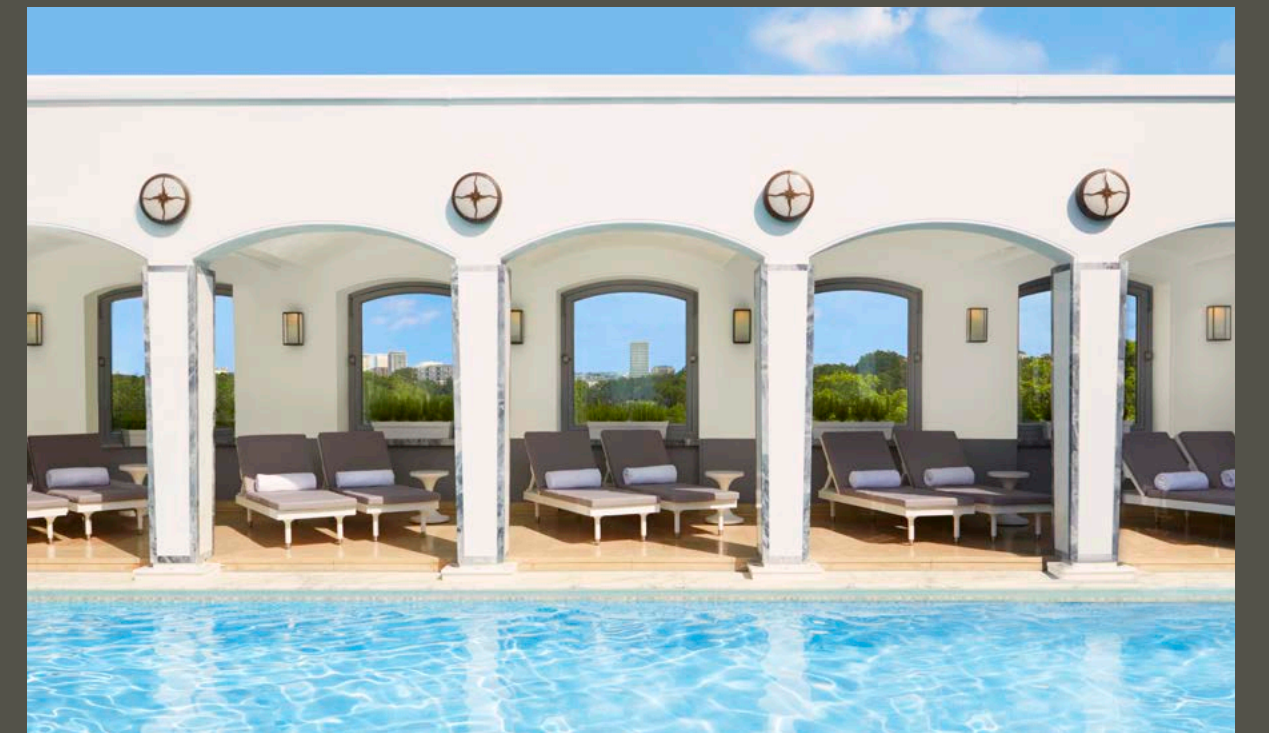



KOFFMANN'S



OPUS SUITE



TERRACE JUNIOR SUITE



# The Berkeley

*From business pow-wows to matches made in heaven, The Berkeley's professional planning team, personal service and airy, light event rooms guarantee memorable occasions for 2 to 450 guests. The event spaces have a dedicated private entrance, all the latest kit and caboodle and were recently re-designed by leading interior designers.*

## KEY FACTS:

There are six distinctive private event spaces at The Berkeley:

### *Ballroom*

Recently refurbished and complete with a private entrance, this magnificent room can be used in conjunction with the adjoining Belgravia Room for a reception.

### *Belgravia Room*

With large windows overlooking Wilton Place, this is a light, spacious and elegant venue perfect for use on its own or in combination with the Ballroom.

### *Mulberry Room*

Recently redecorated with luxurious fabrics and furnishings this sophisticated, graceful room offers comfort and distinguished design.

### *Wilton Room*

Offers a refined atmosphere and seamless facilities with windows facing Wilton Place.

- With a dedicated private events entrance and stunning gallery, complete privacy can be assured with the entire events wing cornered off for your exclusive use.
- Each of the 203 rooms, including 57 suites, at the Berkeley are a study in urbane comfort with simple, beautiful details combined.
- The Berkeley's rooftop pool and Bamford Haybarn Spa provide a slice of countryside calm above the bustle of Knightsbridge.
- Discover two Michelin-starred dining at Marcus; Koffmann's, the legendary chef's eponymous Gascon bistro complete with private dining room for up to 18 guests; the newly refurbished Collin's Room is just the place for delicious British all-day dining and the fashionista's favourite afternoon tea, Prêt-à-Portea; and the Blue Bar is inked in the little black book of those in the know.



# The Berkeley Floor Plan

GROUND LEVEL

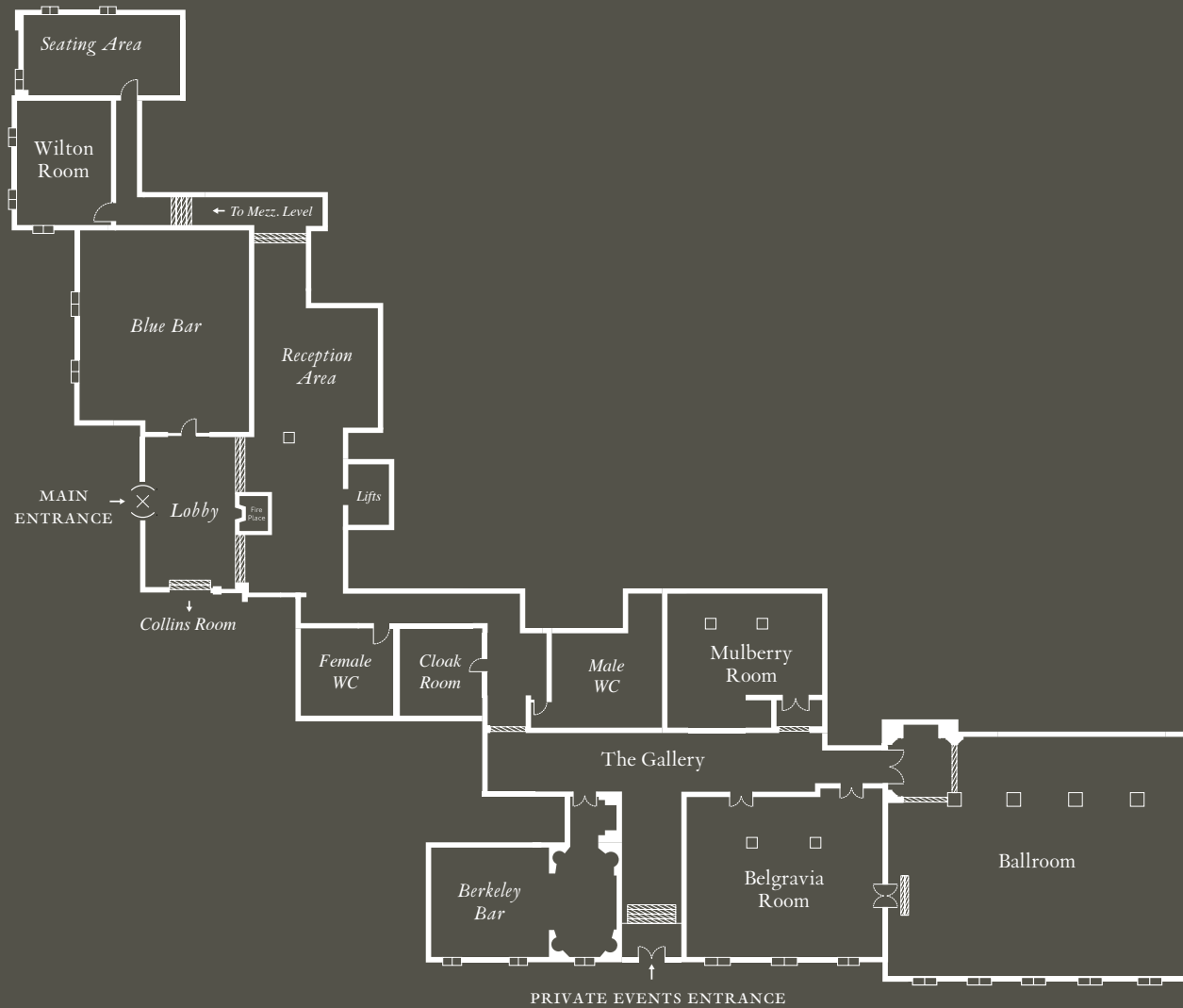

Key □ Pillar ■ Wall ≡ Stairs □ Window ∩ Single Door ∪ Double Doors (X) Revolving Door

# The Berkeley

## ROOM SIZES & CAPACITIES

	TOTAL AREA		DIMENSIONS		CEILING HEIGHT M	CAPACITIES							
	M <sup>2</sup>	FT <sup>2</sup>	M	FT		REC	DIN	THE	CLA	HOL	U-SH	CAB	BOA
BALLROOM	252	2655	18 x 14	59 x 45	3.58 > 2.98	450	200	200	100	60	60	112	54
BELGRAVIA ROOM	94.5	986	10.5 x 9	34 x 29	3.23 > 2.95	150	50	60	40	30	30		30
MULBERRY ROOM	51.68	528	7.6 x 6.8	24 x 22	3.23 > 2.95	40	20	20					18
WILTON ROOM	30.55	315	6.5 x 4.7	21 x 15	2.5 > 2.25	20	14	20					14

REC - RECEPTION; DIN - DINNER; THE - THEATRE; CLA - CLASSROOM; HOL - HOLLOW SQUARE; U-SH - U-SHAPE; CAB - CABARET; BOA - BOARDROOM

BALLROOM



MULBERRY ROOM



BALLROOM



BELGRAVIA ROOM





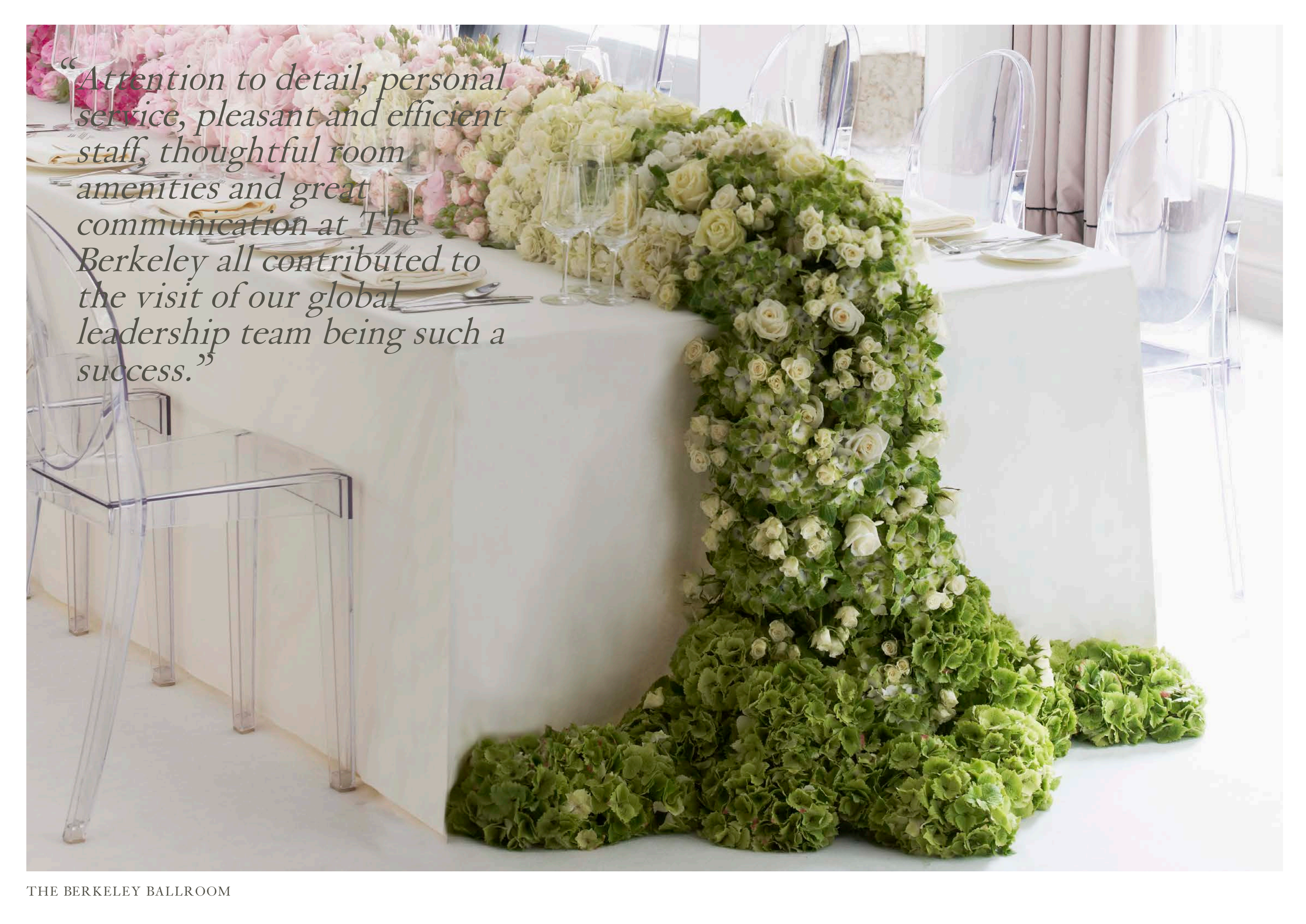

*“Attention to detail, personal service, pleasant and efficient staff, thoughtful room amenities and great communication at The Berkeley all contributed to the visit of our global leadership team being such a success.”*